



Technical specifications and instructions



5CP Plunger pump

Standard Models

5CP5120

5CP5120CSS

Specifications (*)

	Model 5CP5120	Model 5CP5120CSS
Flow	19 l/min	19 l/min
Pressure range	7 to 210 bar	7 to 210 bar
RPM	1420 RPM	1420 RPM

Common specifications

Bore	18 mm
Stroke	18 mm
Inlet pressure range	-2 to 4 bar
Crankcase capacity	0,51 L
Maximum liquid temperature	71° C
Inlet ports (2)	1/2" NPTF
Discharge ports (2)	3/8" NPTF
Shaft diameter	20 mm
Weight	9 kg
Dimensions (pump only)	277 x 254 x 147 mm

(*) Abnormalities permitted only after consultation and written confirmation from Cat Pumps.

Exploded View

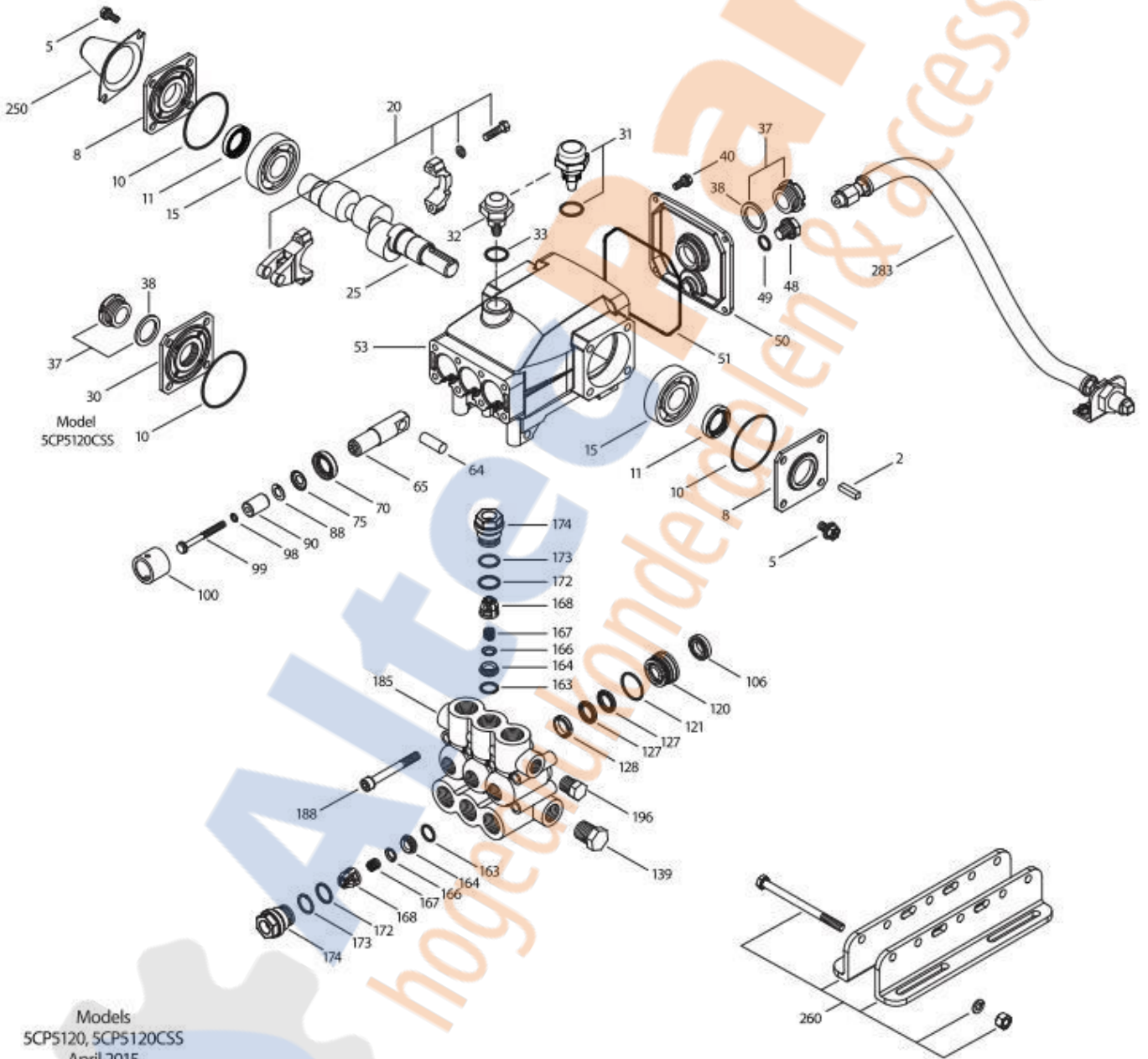

Parts list

It.	Num.	Mat.	Description	Qt
5CP5120				
5CP5120CSS				
2	30057	STL	Key (M6x6x25)	1
5	96031	STZP	Screw, HHC sems (M8x16)	8
	126542	STCP R	Screw, HHC sems (M8x16)	8
8	46910	AL	Cover, bearing	2-1
10	14028	NBR	O-ring, bearing cover – 70D	2
11	43222	NBR	Seal, oil, crankshaft – 70D	2-1
15	14480	STL	Bearing, ball	2
20	48742	TNM	Rod, connecting assy {10/01}	3
25	46928	FCM	Crankshaft, dual end, M18 – 5CP5120	1
	48233	FCM	Crankshaft, dual end, M18 – 5CP5120CSS	1
30	49776	AL	Cover, bearing – 5CP5120CSS	1
31	127409	-	Cap, vented w/O-ring (Rain cap)	1
32	46798	-	Cap, oil filler, domed	1
33	14179	NBR	O-ring, oil filler cap – 70D	1
37	92241	-	Gauge, oil, bubble w/gasket – 80D	1-2
38	44428	NBR	Gasket, flat, oil gauge – 80D	1-2
40	92519	STZP	Screw, HHC sems (M6x16)	4
	125824	STCP R	Screw, HHC sems (M6x16)	4
48	25625	STCP	Plug, drain (1/4"x19BSP)	1
49	23170	NBR	O-ring, drain plug – 70D	1
50	46940	AL	Cover, rear	1
51	14044	NBR	O-ring, rear cover	1
53	48617	AL	Crankcase	1
64	46746	CM	Pin, crosshead	3
65	48458	BBNP	Rod, plunger	3
70	46838	NBR	Seal, oil, crankcase – 70D	3
75	43328	S	Slinger, barrier	3
88	45697	S	Washer, keyhole (M18x10)	3
90	49655	CC	Plunger (M18x50)	3
98	46730	NBR	Washer, seal – 90D	3
	48394	FPM	Washer, seal – 90D	3
	# 48432	EPDM	Washer, seal	3
99	+ 48201	SS	Retainer, plunger w/stud (M6)	3
100	46749	PVDF	Retainer, seal	3
106	43243	NBR	Seal, LPS w/S-Spg	3
	44926	FPM	Seal, LPS w/SS-Spg	3
	# 46651	EPDM	Seal, LPS w/SS-Spg	3
	76243	ST2	Seal, LPS w/S-Spg	3
120	49657	BB	Case, seal (press-in-style)	3
121	13978	NBR	O-ring, seal case – 70D	3
	14329	FPM	O-ring, seal case	3
	# 48904	EPDM	O-ring, seal case	3
127	44549	SNG	V-packing	6
	45617	SFG	V-packing	6
	48300	STG	V-packing	6
128	45618	BB	Adapter, male	3
139	22179	BBCP	Plug, inlet (1/2"NPTM)	1
163	17547	NBR	O-ring, seat – 85D	6
	11685	FPM	O-ring, seat – 85D	6
	# 46648	EPDM	O-ring, seat – 70D	6
164	45790	S	Seat	6
166	46429	S	Valve	6

167	43750	S	Spring	6
168	+ 44565	PVDF	Retainer, spring	6
172	17549	NBR	O-ring, valve plug – 70D	6
	26996	FPM	O-ring, valve plug – 70D	6
	# 49133	EPDM	O-ring, valve plug	6
173	48365	D	Back-up-ring, valve plug	6
174	45900	BB	Plug, valve	6
185	46895	FBB	Manifold, head	1
188	126513	STCP R	Screw, HSH (M8x70)	8
196	22187	BBCP	Plug, discharge (3/8"NPTM)	1
250	118672	STCP	Protector, shaft (model 5CP5120 only)	1
255	30243	STZP	Mount, direct	1
260	30611	STZP R	Mount, rail, assy (4.22")	1
	30613	STZP R	Mount, rail, assy (5.02")	1
	76513	STZP R	Mount, rail, assy (5.52")	1
	30637	STZP	Mount, angle assy-retro fit (see TB 078)	1
265	30659	-	Kit, complete mounting (incl 30611,30633,118672) (model 5CP5120 only)	1
275	30944	STL	Assembly, Hub & Key (incl 30945, 30057)	1
283	34334	-	Kit, oil drain (3/8"x24")	1
	76334	-	Kit, oil indicator (3/8"x24")	1
299	814844	FBB	Head, complete Standard	1
300	33630	NBR	Kit, seal (incls: 98,106,121,127) standard	1
	31350	FPM*	Kit, seal (incls: 98,106,121,127)	1
	76645	HT	Kit, seal (incls: 98,106,121,127)	1
	# 76630	EPDM	Kit, seal (incls: 98,106,121,127)	1
	76960	STHT	Kit, seal (incls: 98,106,121,127) (after 2/09)	1
310	33060	NBR	Kit, valve (incls: 163,164,166,167,168,172,173) standard	2
	31345	FPM	Kit, valve (incls: 163,164,166,167,168,172,173)	2
	# 31735	EPDM	Kit, valve (incls: 163,164,166,167,168,172,173)	2

Bold print numbers are unique to a particular pump model. Italics are optional items. { } Date of latest production change.

Silicone oil/grease required. + Production parts are different than repair parts. R Components comply with RoHS directive.

* Review individual parts in each kit for material identification.

View 'Tech Bulletins' 002, 003, 024, 036, 043, 053, 060, 061, 064, 073, 074, 077, 078 and 083 for additional information.

Material codes: (not part or part number)

AL	Aluminum	FCM	Forged chrome-moly	ST2	Special blend PTFE grey
BB	Brass	FPM	Fluorocarbon	STCP	Steel / chrome plated
BBCP	Brass / chrome plated	HT	Hi-Temp (EPDM alternative)	STG	Special blend PTFE white
BBNP	Brass nickel plated	NBR	Medium nitrile (Buna-N)	STHT	Special PTFE High temp
CC	Ceramic	PVDF	Polyvinylidene fluoride	STL	Steel
CM	Chrome-moly	S	304 stainless steel	STZP	Steel / zinc plated
D	Acetal	SFG	Special blend FPM	TNM	Special high strength
EPDM	Ethylene propylene diene mon.	SNG	Special blend (Buna)		
FBB	Forged brass	SS	316 stainless steel		